

Typical application of direct regrind feedback.

- A Two-component proportioning valve
- B Conveying unit
- C Conveying control
- D Safety filter
- E Vacuum pump
- F Granulator
- G Injection molding machine

Component F is described below.

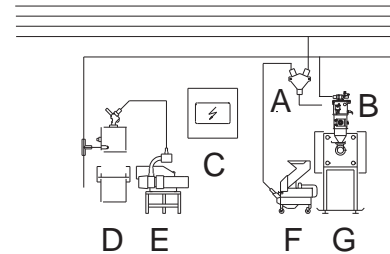

## Brief Description

Portable, slow running granulator with feed chute, motor overload protection and visual alarm signal. Easy to maintain and quick to clean. Hinged construction allows easy accessibility to the cutting chamber.

Handles all sprues and rejects from injection molding machines.

- Colortronic granulators are easy to maintain and designed for a 7 day, 24 hour operation.
- Colortronic granulators meet the european "CE" requirements.



## Technical Data

### Basic Version

- Maintenance free drive
- HSS milling rotor with 6 rotor blades
- 2 HSS steel stator blades
- Hardened perforated screen with various holes sizes available  $\varnothing$  3, 4, 5, 6, 8 mm / .12, .16, .20, .24, .31 in.
- Feed chute

### Optional Equipment

- Overfill protection with dry contact output for external alarm
- Special feed chute designs
- HSS stator blades
- Hardened perforated screen with various holes sizes available  $\varnothing$  3, 4, 6, 10 mm / .12, .16, .24, .4 in.
- Special voltages
- Blade setting tool
- Suction probe 50 mm

### Performance

- Maximum material size 80 x 60 mm
- Maximum throughput 12 kg/h / 26.4 lb/h
- Connected load appr. 0,8 kW
- Cutting size 250 mm
- Rotor speed 95 rpm
- Color
  - Motor blue, RAL 5011
  - Chassis blue, RAL 5017
  - Housing white, RAL 9016
- Weight: ca. 60 kg

## Drawing

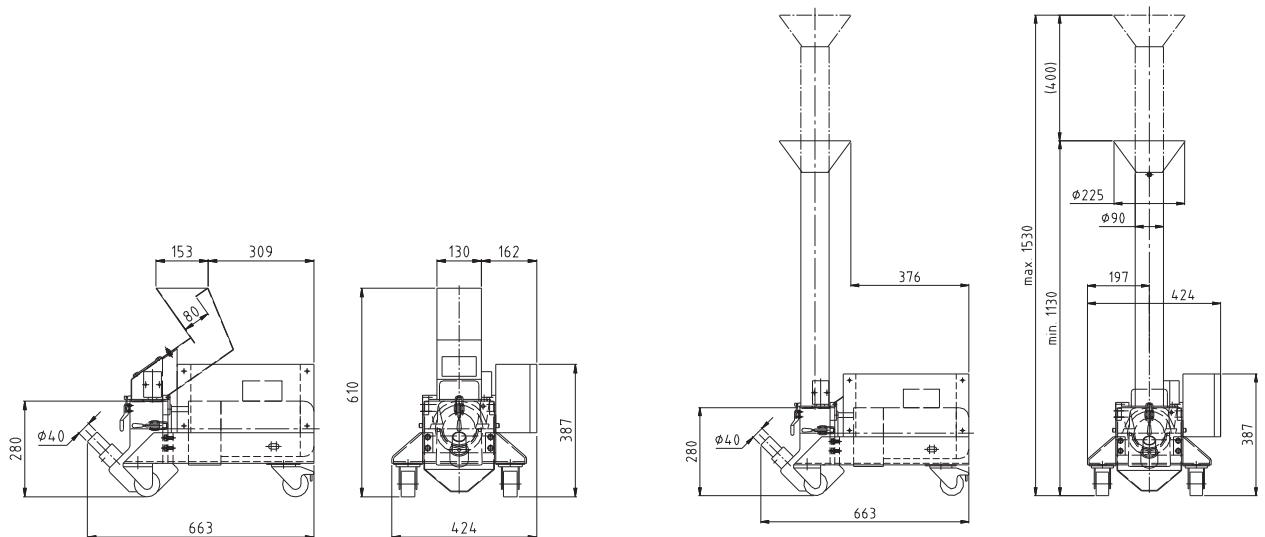

M 75-T

M 75-RT

[www.colortronic.com](http://www.colortronic.com)

**Colortronic AG**  
 Neulandweg 3  
 CH 5502 Hunzenschwil  
 Schweiz

☎ +41 62 889 25 25  
 📠 +41 62 889 25 26  
 ✉ [info@colortronic.ch](mailto:info@colortronic.ch)

**Colortronic Inc.**  
 155 E. 9th Avenue  
 Runnemede, NJ 08078  
 USA

☎ +1 856 312 96 00  
 📠 +1 856 312 96 96  
 ✉ [ctusa@colortronic.com](mailto:ctusa@colortronic.com)

**Colortronic Systems Pte. Ltd**  
 71 Ayer Rajah Crescent 07-19 to 07-21  
 Ayer Rajah Industrial Estate  
 Singapore 139951  
 Singapore

☎ +65 77 77 665  
 📠 +65 77 88 671  
 ✉ [ctasia@colortronic.com](mailto:ctasia@colortronic.com)